



Health & Energy Assessment Team

16 Shawhill Road
Annan
Dumfriesshire
DG12 6JY

01461 206607 t
07813 122848 m
dea_epc@tiscali.co.uk e

Floor Plan Report

HEAT was commissioned by XXXXXX, XXXX to provide a drawing of the premises known as XXXXXX, XXXX, XXXX. The following criteria were used;





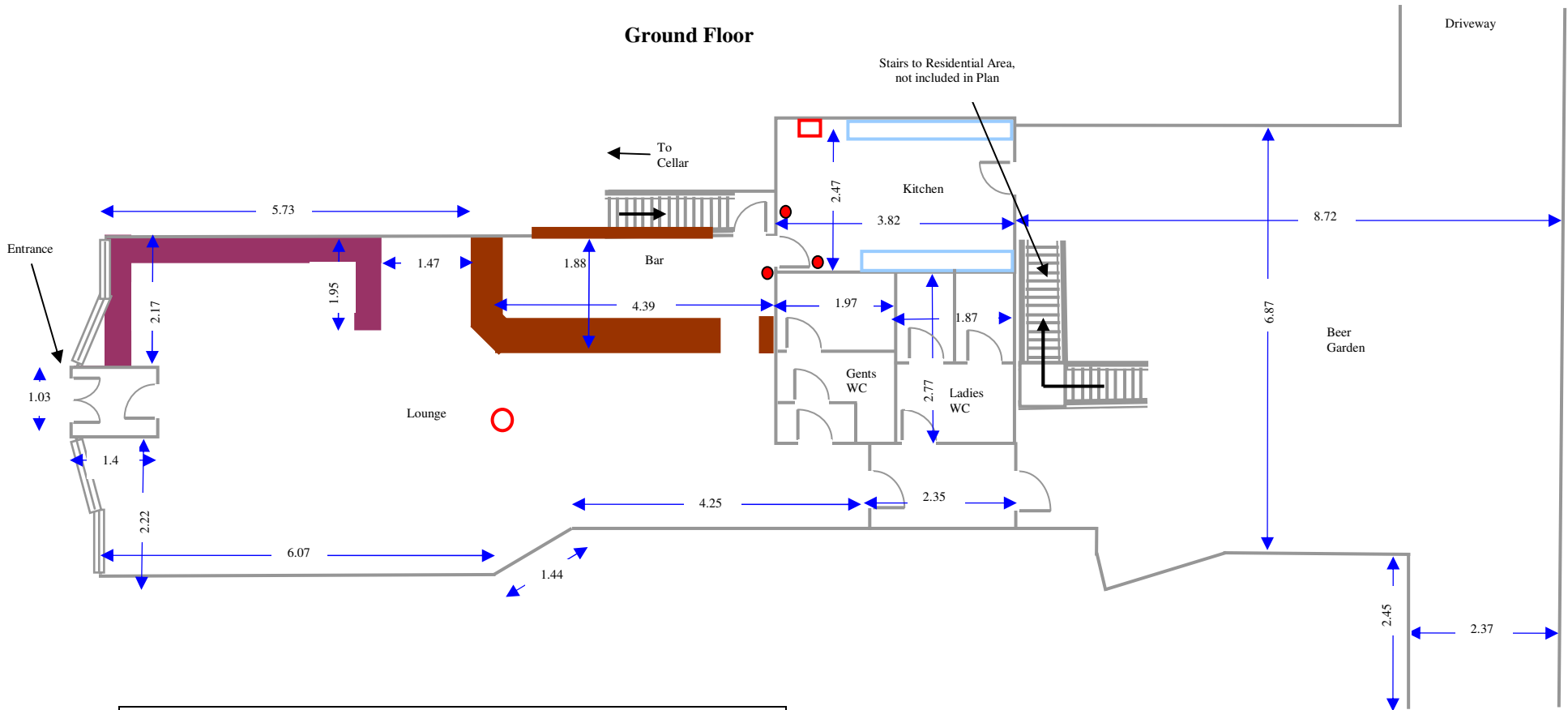

Applications must include certain stipulated information including:

- 🏠 Scale 1:100
- 🏠 Perimeter, rooms, kitchens & public conveniences.
- 🏠 Entry & exit points, also of escape routes.
- 🏠 Location and height of any stage or raised area, steps, stairs, lifts etc.
- 🏠 Location and type of any fire safety equipment and other safety equipment.
- 🏠 The location and extent of the boundary of the building, if relevant, and, if different, the perimeter of the premises
- 🏠 The location of points of access to and egress from the premises
- 🏠 In a case where the premises is used for more than one existing licensable activity, the area within the premises used for each activity
- 🏠 In a case where an existing licensable activity relates to the sale of alcohol, the location or locations on the premises which is or are used for the consumption of alcohol
- 🏠 Fixed structures (including furniture) or similar objects temporarily in a fixed location (but not furniture) which may impact on the ability of individuals on the premises to use exits or escape routes without impediment

Ground Floor

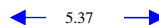

Legend

- Fire Extinguisher** 
- Smoke Detector** 
- Fire Blanket** 
- Window** 
- Fixed Seating** 
- Sinks / Worktops** 
- Fixed Furniture**  Height 1.10m, Width 0.56m
- Measured length in metres**  5.37

Notes

All measurements taken internally

Scale 1:100

Cellar

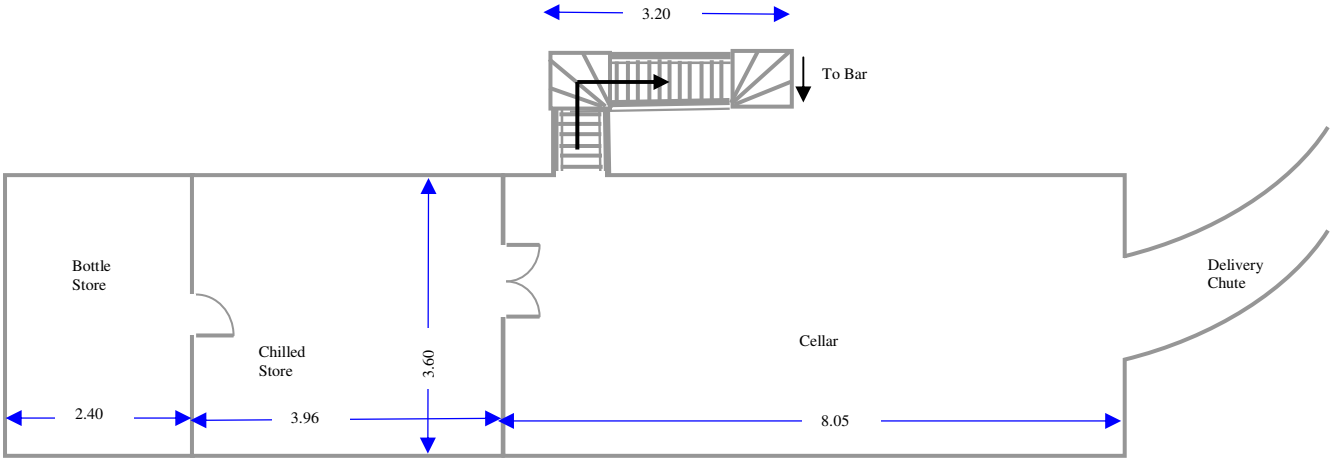

Legend

- Fire Extinguisher**
- Smoke Detector**
- Fire Blanket**
- Window**
- Fixed Seating**
- Sinks / Worktops**
- Fixed Furniture** Height 1.10m, Width 0.56m
- Measured length in metres** 5.37

Notes

All measurements taken internally

Scale 1:100